

Revised August 2016



STEEL: 18106,18107,18108  
ALUMINUM: 18126,18127,18128

## REAR FLIP SEAT

WILL FIT CLUB CAR® DS®  
INSTALLATION INSTRUCTIONS

### INCLUDED:

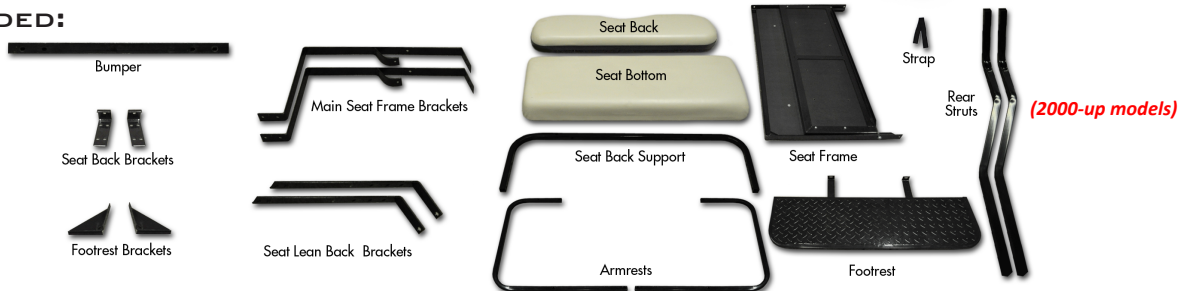

**Note: For CC DS model years 1981-1999, rear candy cane struts are required to mount top. Struts sold separately**

Remove all rear accessories (if any), canopy, struts, bumper, motor cover, front seat and bracket. Retain canopy hardware. You will need it later.



# 2

Install bumper with hardware from pack 1.



3  
Install main seat frame brackets and front seat lean back brackets to front with retained hardware. Using 8mm hardware from pack 1, mount middle bracket to cart.



4  
Slide footrest bracket between main seat frame brackets and bumper. Install footrest using hardware from pack 1.



5  
Attach seat frame to the front portion of the main frame brackets using hardware from pack 2.

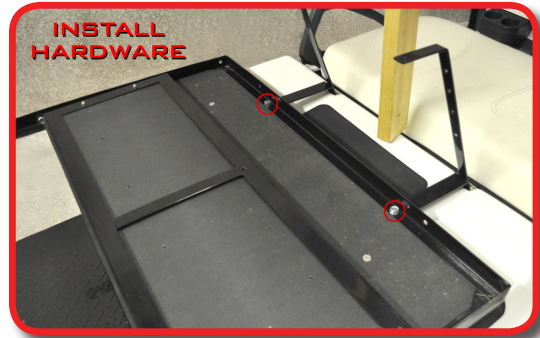

6  
Attach seat frame to the main frame brackets using hardware from pack 2.

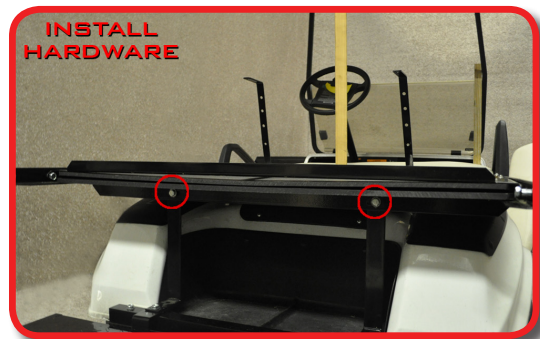

# 7

Attach seat back support and armrests using hardware from pack 3.



# 8

Attach footrest brackets to footrest and armrests using hardware from pack 3.



# 9

Attach seat back brackets to seat back using hardware from pack 4 and tighten.



# 10

Attach seat back to seat back support using hardware from pack 5. Now you can tighten all hardware.

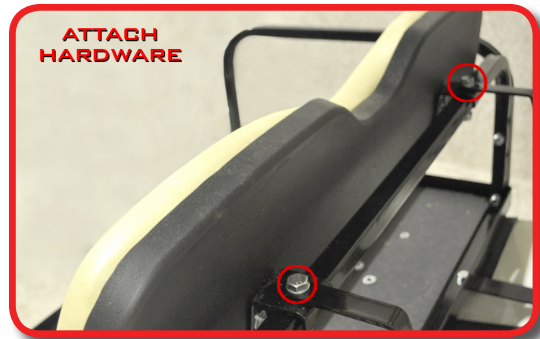

11

Attach struts to seat back support using hardware from pack 5.

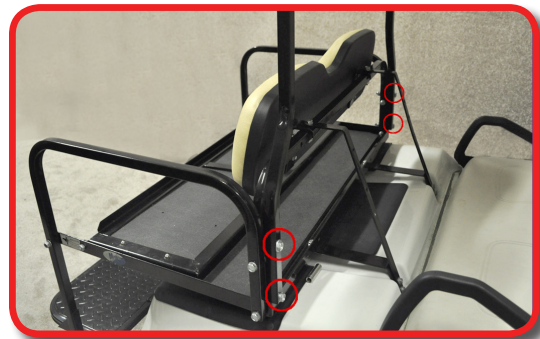

12

Attach seat bottom and strap to seat frame using hardware from pack 6.



13

Attach canopy using hardware from step 1.



**INSTALLATION COMPLETE**

