



CP-0106 Secondary Clutch Kit, Heavy Duty

Yamaha G2-G22

Installation Instructions

Caution: Please read through the cart's safety information and maintenance instructions before installing this product. Clutches are under a lot of spring pressure. Releasing the pressure prematurely could cause injury. **Safety glasses should be worn at all times.** Remove the system's positive and negative connections from the battery before starting the installation. Do not use oil or grease on the clutch surfaces that will come in contact with the drive belt.

Secondary Clutch Removal

1. Turn the key to the OFF position. Engage the parking brake.

NOTE: This installation can be performed by removing the front seat bottom, rear body or driver side wheel and fender.

2. With the cart in neutral, remove the drive belt.
3. Place the cart in gear to prevent the clutch from rotating.
4. Attach the secondary sheave holder (Yamaha YG-40103-B) around the sliding sheave and spring seat.
5. Remove the cotter pin, nut and washer. Attach the clutch puller (CP-0034 recommended). Tighten the puller's center bolt until the fixed sheave is removed.

6. Remove the woodruff key and inner washer. Carefully remove the sheave holder from the sliding sheave. Push in the sliding sheave by hand to slowly release the spring tension. Remove the sliding sheave, spring, spring seat and retaining clip.

CAUTION: Be cautious of pre-loaded spring tension.

Secondary Clutch Installation

1. Install the input spacer included with the kit. The spline side of the spacer should face away from the shaft.
2. Make sure the keyway on the shaft is facing up and the cart is in gear.
3. Grease the bushing and oil seal lips inside of the sliding sheave.
4. Place the spring seat, spring and sliding sheave onto the shaft. Rotate the sliding sheave so the raised areas fit into the recessed areas of the spring seat.
5. Use a compression tool to carefully compress the spring seat, spring and sliding sheave. Use the sheave holder to keep the assembly secure. The keyway on the shaft should be visible.

NOTE: The heavy duty spring does not have to be preloaded.

6. Remove any oil or grease from the tapered portion of the input shaft and fixed sheave using a non-greasy solvent.
7. Install the plastic washer, woodruff key, fixed sheave, washer, nut and cotter pin. Per OE Specifications, torque the nut to the following values: G9-G14: 60 Nm (43 ft.lb.); G16-G22: 65 Nm (47 Ft.lb.).
8. Remove any excess grease from the sheaves and input shaft.
9. Install the drive belt.

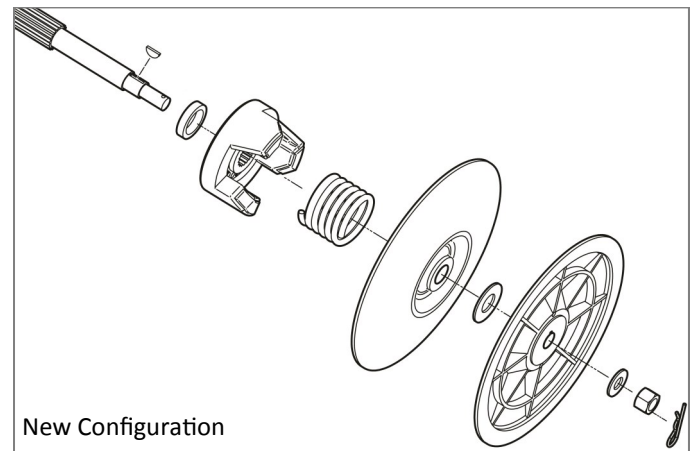
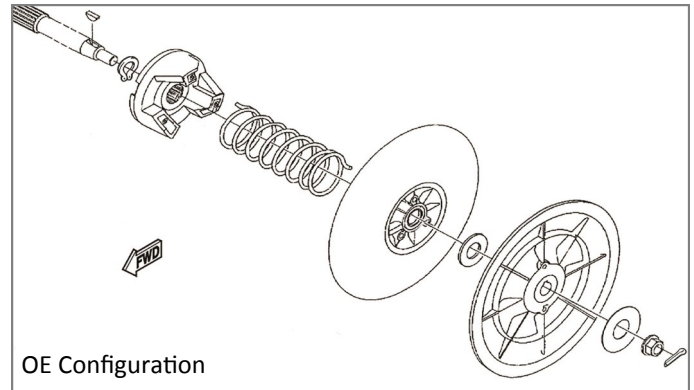

This completes the installation of your secondary clutch kit. Please enjoy safely!